

## SKAKOGAB

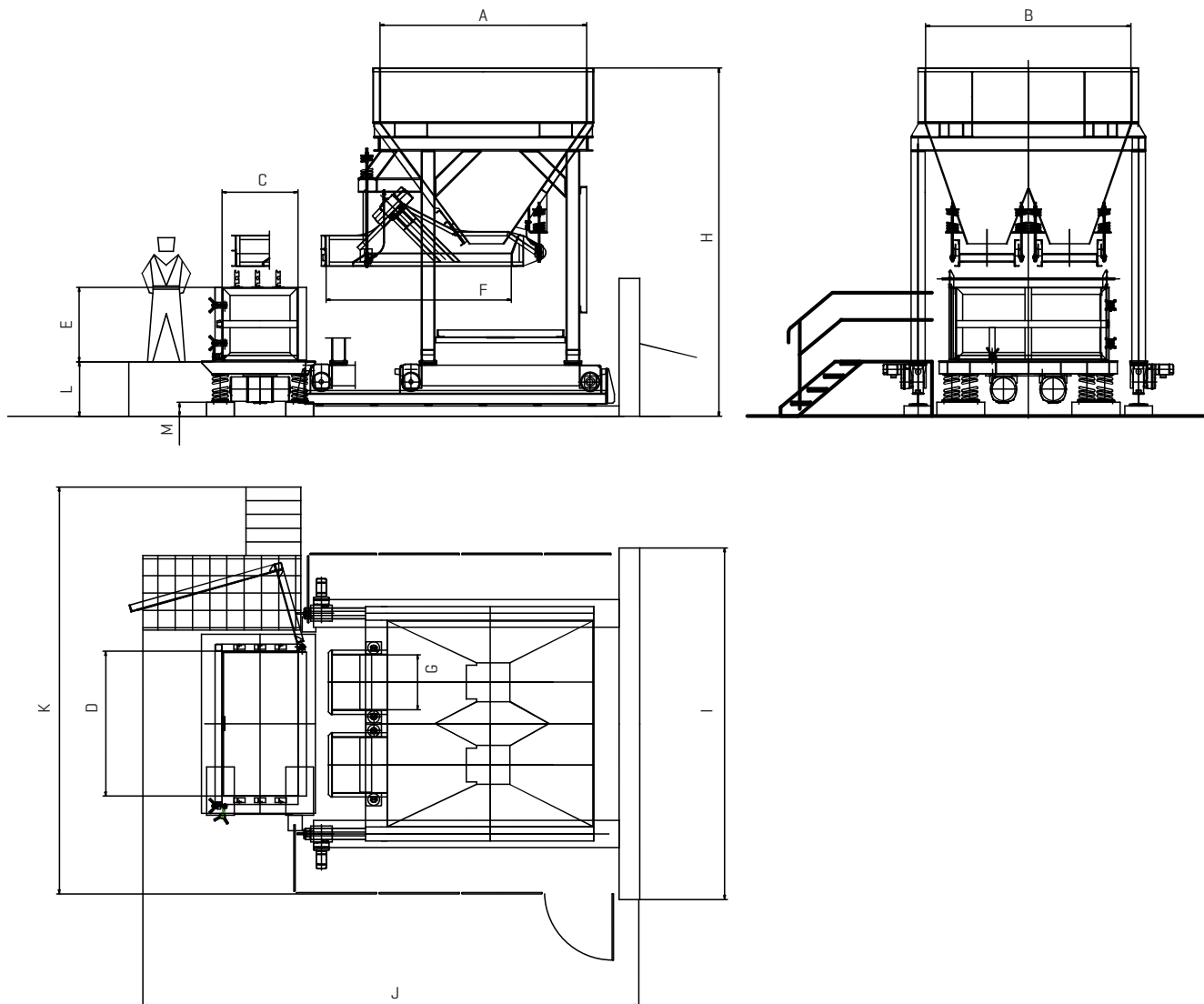

INSTALLATION REQUIREMENTS [mm]													
A	B	C	D	E	F	G	H	I	J	K	L	M	
3000	3000	1100	2100	1100	2600	800	5000	5100	7200	5900	800	200	

MOTOR SIZE [kW]	
Hopper	2 x 0,32
Feeder FCU080/0260M2C	2 x 3,0
Table S1U100/0200M1C	2 x 7,0

Hopper Capacity	10 m <sup>3</sup>
Grain Size	60-150 mm
GABION Loading Time	3 min

12-05-2013

Please contact us for further information regarding exact dimensions and installations.  
**SKAKO Vibration** retains all rights to change the above specifications without notice.

**SKAKOGAB**

**- With fine Recovering (Option)**

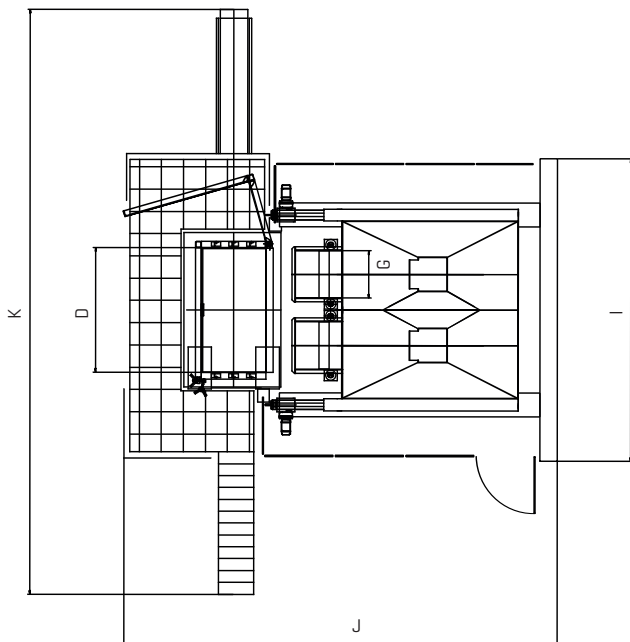
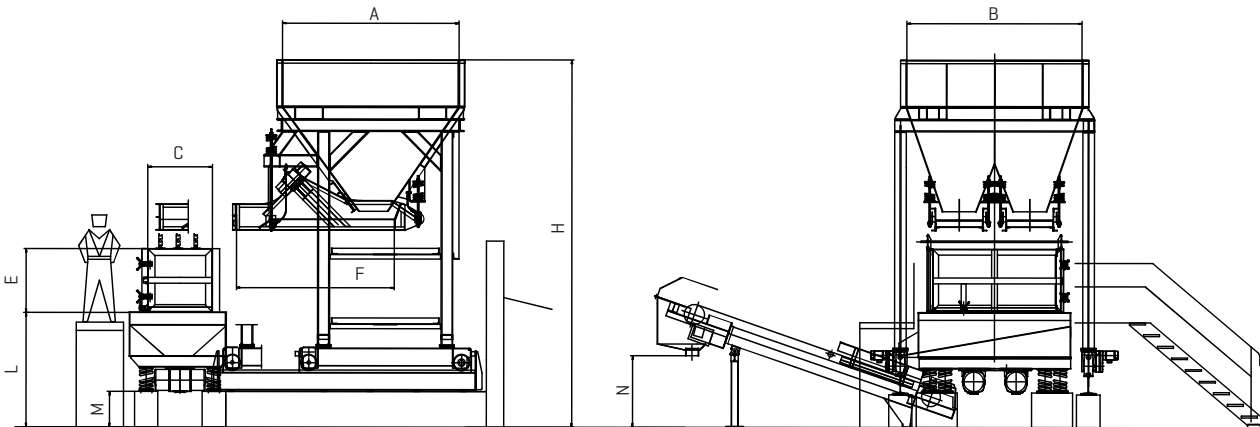

INSTALLATION REQUIREMENTS [mm]													
A	B	C	D	E	F	G	H	I	J	K	L	M	N
3000	3000	1100	2100	1100	2600	800	6200	5100	7200	9800	1900	600	1200

MOTOR SIZE [kW]	
<b>Hopper</b>	2 x 0,32
<b>Feeder FCU080/0260M2C</b>	2 x 3,0
<b>Table S1U100/0200M1C</b>	2 x 7,0
<b>Belt Conveyor 500 x 4500</b>	1,1

<b>Hopper Capacity</b>	10 m <sup>3</sup>
<b>Grain Size</b>	60-150 mm
<b>GABION Loading Time</b>	3 min

SKAKO VIBRATION retains all rights to change or improve the above specifications without notice

12-05-2013

Please contact us for further information regarding exact dimensions and installations.  
**SKAKO Vibration** retains all rights to change the above specifications without notice.